



**INSTALLATION  
INSTRUCTIONS**



**Part # 12129100**



**Front Sway Bar**

**1979-1993 Ford Mustang**



[www.ridetech.com](http://www.ridetech.com)  
812.482.2932



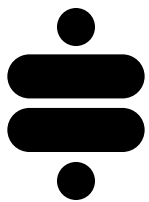

**Please Read And Understand All Instructions  
And Warnings Prior To The Installation Of  
This Product.**



**THANK YOU**

Congratulations on your new Ridetech product! It's an honor that you've selected the Ridetech brand to upgrade your ride. Our products are developed around quality and performance without compromise. We're confident you'll have many years (and miles) of pure driving enjoyment.  
Thank you for choosing Ridetech!

### Road Map

<b>Exploded View &amp; Parts Listing</b>	<b>3</b>
<b>Sway Bar Installation</b>	<b>4-5</b>
<b>End Link Assembly</b>	<b>6</b>

This sway bar features 3 tuning positions to help optimize your car's handling. See the chart and illustration below for hole locations and their associated stiffness rating. We encourage you to drive the car at each position to experience the change in handling characteristics and dial in your preferred setting.

<b>Sway Bar Rates</b>	
<b>Position</b>	<b>Rate (lb/in)</b>
1	2200
2	1600
3	1350

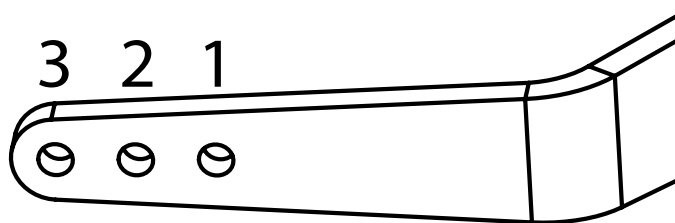

**NOTE: The bushings in this kit contain an anti-friction lining.  
No lubrication is required.**

# EXPLODED VIEWS AND PARTS LISTING

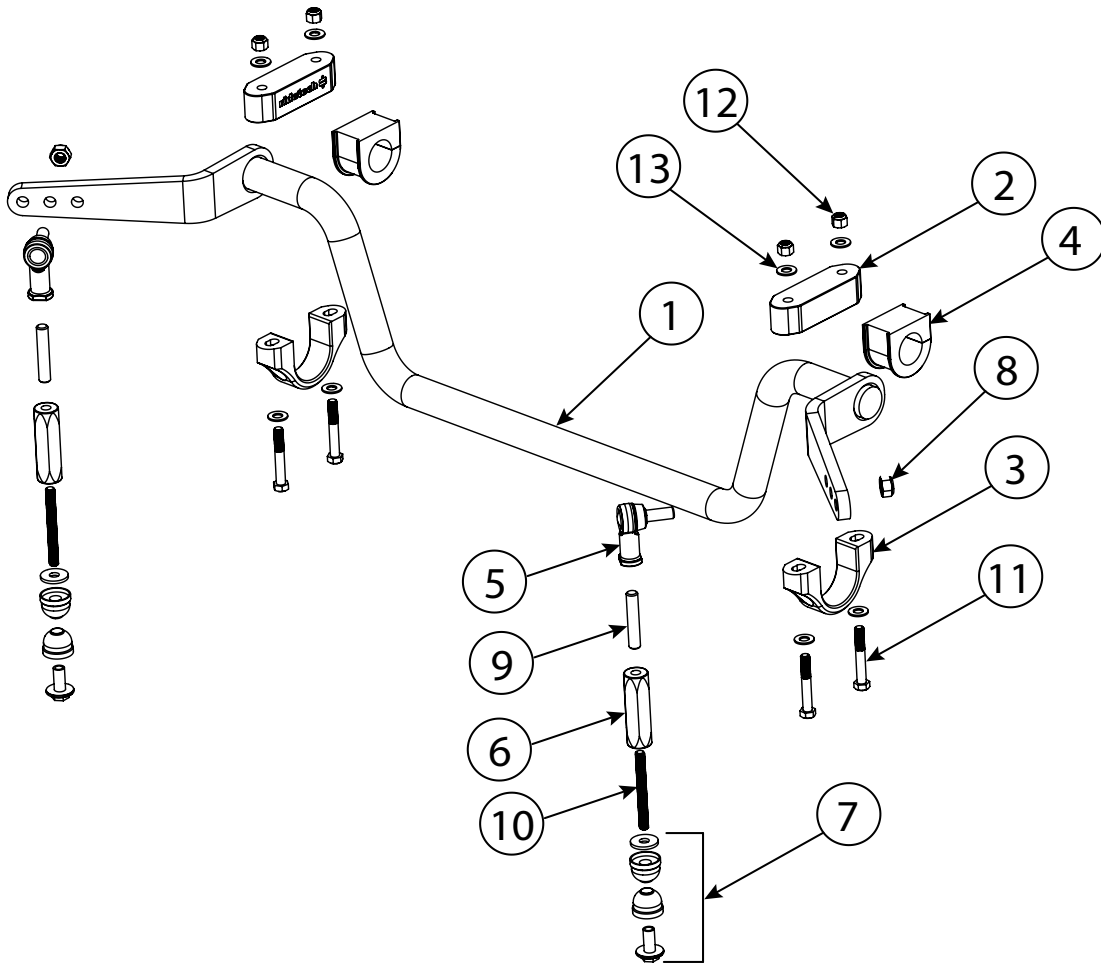

ITEM #	PART #	DESCRIPTION	QTY
1	90001135	FRONT SWAY BAR	1
2	90001137	SPACER BLOCK	2
3	90001346	BILLET MOUNT	2
4	70015015	SWAY BAR BUSHING	2
5	90003843	90-DEGREE ELBOW	2
6	90001136	END LINK ADAPTER	2
7	90002930	END LINK KIT	2

Hardware Kit: 99010275			
Item #	Part #	Description	QTY
<b>END LINK</b>			
8	99122001	M12-1.75 NYLOK NUT	2
9	99125002	M12-1.75 x 60mm (2.50") FULLY THREADED STUD	2
10	99375014	3/8-16 X 3.50" FULLY THREADED STUD	2
	90002263	RED LOCTITE	1
<b>BUSHING STRAP</b>			
11	99375004	3/8-16 X 2.50" HEX CAP SCREW	4
12	99372001	3/8-16 NYLOK NUT	4
13	99373002	3/8" FLAT WASHER	8

# Sway Bar Installation

1. Raise the vehicle to a safe and comfortable working height.
2. Remove the existing sway bar. Refer to the factory service manual for the proper disassembly procedure.
3. Spread open each bushing and install onto the bar (Figure 1).

4. Slide a billet strap over each bushing as shown in Figure 2.

5. Insert a 3/8"-16 bolt with washer into each hole of the billet strap. Slide the spacer block onto the bolts.

Position the sway bar in the car at the original mounting location (Figure 3). A second set of hands may be helpful here.

Line up the bolts/straps/blocks with the holes in the original sway bar mounting location and insert the bolts into the mounting holes.

Secure with a 3/8" flat washer and nylok nut on each bolt.

**Leave the bolts hand tight for now.**



Figure 1



Figure 2

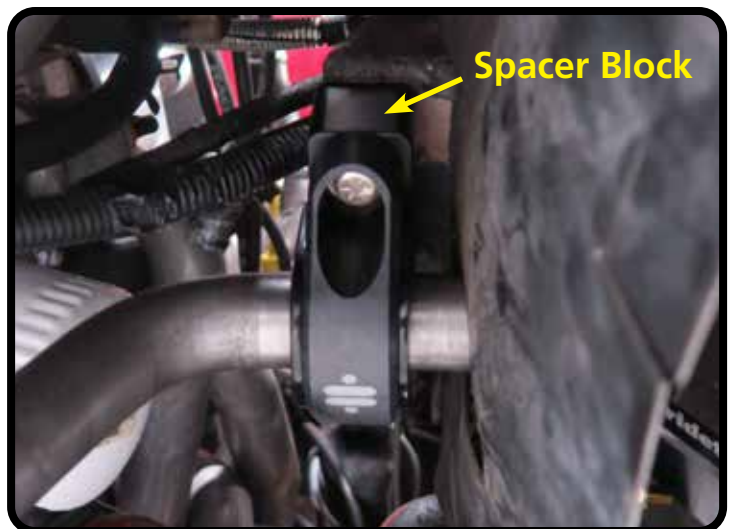

Figure 3

## Sway Bar Installation

**6.** Assemble each of the end links as shown in Figure 6 on the next page. You will only require a portion of each of the provided Moog end link kits (See Figure 7).

**7.** Install the stud of the 90-degree end of the end link into one of the holes of the sway bar arm. See the chart on page 2 for each hole's stiffness rating. We recommend starting at hole #1 and tuning from there (Figure 4).

Install a 3/8" nylok nut on the upper end link stud and torque to **35 ft-lbs**.

**8.** Install the straight end of the end link into the mounting flange on the lower control arm. Refer to the illustration in Figure 6 for an assembly guide.

Thread the barrel nut/washer onto the stud until they are flush with the lower bushing, and then apply 2 more turns (Figure 5).

**9.** You may now tighten the 3/8" billet strap bolts/nuts from step 5. Torque to **35 ft-lbs**.



Figure 4



Figure 5

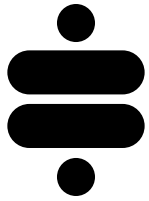

# END LINK ASSEMBLY

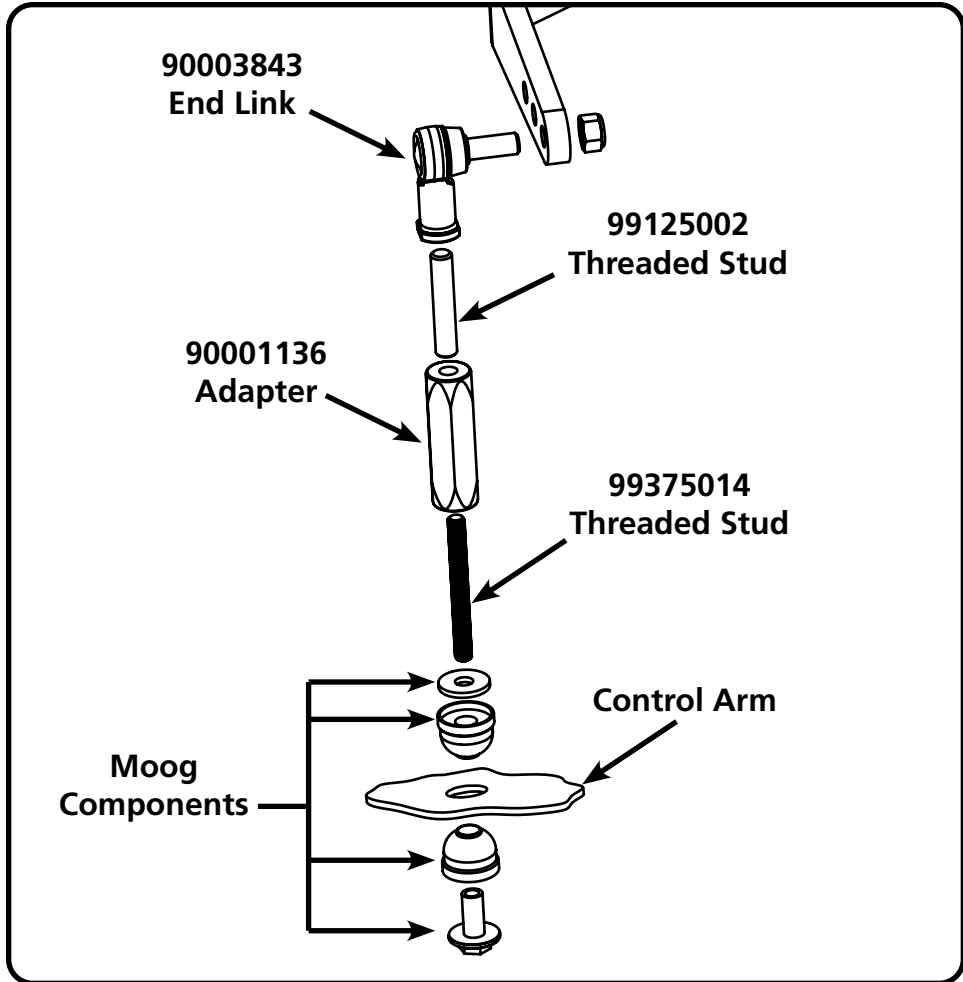
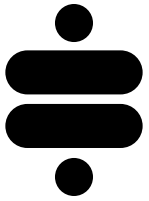

Figure 6

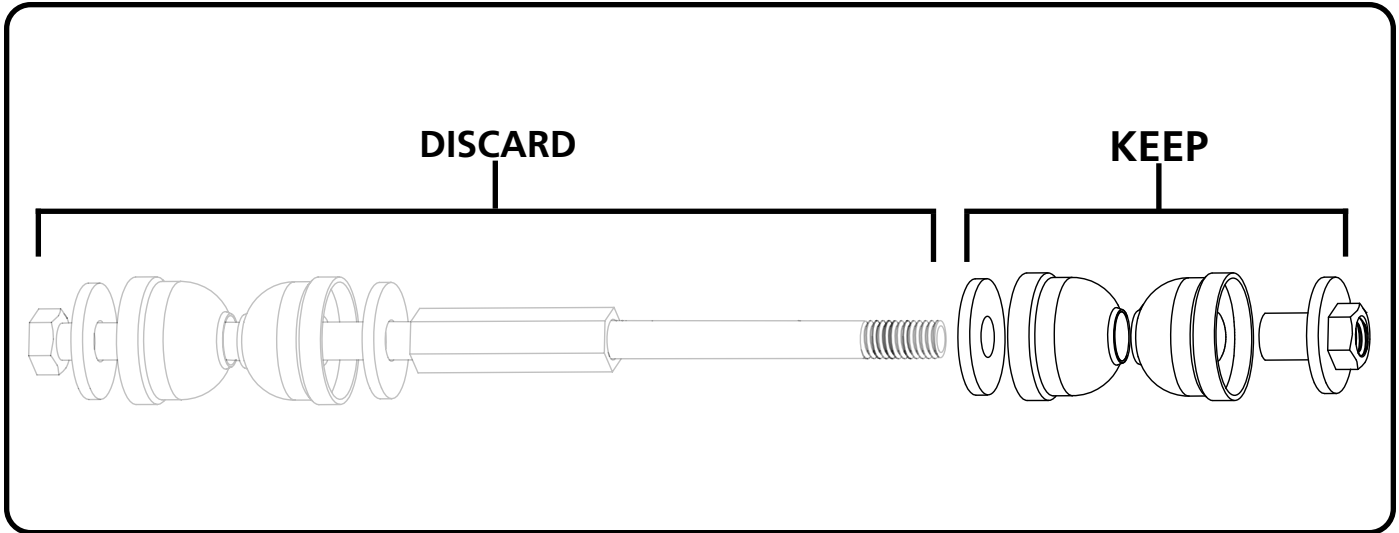

Figure 7